

Model NO. : SSL-02

All in one Solar Street Lights 2000Lumens

High quality/Efficiency/Energy Saving

Application: High way/Park/Street/Roadway/Parking

Lot/Public square/ plaza/Campus/Airfield/Farm &

Ranch/Remote Area/Military Base/Government

project for special use

Categories: [Solar Street Light](#)

www.usaemergencysolarenergy.com PH+1-303-634-2208

Fax: +1-303-634-2208 Email: sales@usaemergencysolarenergy.com



www.usaemergencysolarenergy.com PH+1-303-634-2208 Fax: +1-303-634-2208 Email: sales@usaemergencysolarenergy.com

<p>Features: Elegant Integrated Design, Aluminum alloy case 48pcs Super-bright LEDs,2000Lumens brightness equal to 200W normal lamp 15W solar panel and the battery can be easily replaced by users Night sensor + PIR motion sensor 120° wide lighting angle Support 3 nights after full charging. Easy to install and Auto on/off/PIR</p>		price per unit	100 pcs Price			
		us\$265.45 BUY NOW	us\$235.84 BUY NOW			
LED	2000Lumens,6000K±500K	Lighting mode				
Li-ion battery	26000 mAh ,3.7V	600 lumens for first 5 hrs + 300 lumens DIM light with PIR 2000lumens full brightness till dawn				
Solar Panel	15W, 5.5V					
Install height	3~4 meters	Application: Courtyard/Garden/ Park/Street/Roadway/pathway/Parking Lot/Private road/Sidewalk/Public square/ plaza/Campus/Airfield/Farm & Ranch/Perimeter Security/ Wildlife area/Remote Area/Military Base				
Waterproof	IP 65					
Solar charging time	9~10 hours by bright sunlight					
Lighting time	Over 3 nights	Packing details: Retail packaging: L27*W19.5*H85CM Carton size: L29*W42*H88CM QTY/CTNS: 2PCS G.W/CTNS: 16.5KG www.usaemergencysolarenergy.com PH+1-303-634-2208 Fax: +1-303-634-2208 Email: sales@usaemergencysolarenergy.com				
Material	Aluminium alloy + toughened glass					
Size	808*227*164mm					
Warranty	3 years					



www.usaemergencysolarenergy.com
PH+1-303-634-2208 Fax: +1-303-634-2208
Email: sales@usaemergencysolarenergy.com

www.usaemergencysolarenergy.com PH+1-303-634-2208
Fax: +1-303-634-2208 Email:
sales@usaemergencysolarenergy.com





www.usaemergencysolarenergy.com PH+1-303-634-2208
Fax: +1-303-634-2208 Email:
sales@usaemergencysolarenergy.com



•PRODUCTS DETAIL

Main Features:

- 1.Design: Solar panel, Battery, LED panel are all in One Integrated Design
- 2.Solar panel: High efficiency Glass Lamination panel
- 3.LED: High quality LED 120 lumen/W
- 4.Battery : A graded Li-ion battery No.18650
- 5.PIR :Motion sensor distance over 7M
- 6.Waterproof: IP65

Material : Aluminum Alloy + Tempered Glass

www.usaemergencysolarenergy.com PH+1-303-634-2208

Fax: +1-303-634-2208 Email: sales@usaemergencysolarenergy.com

Working process instructions

Use the supplied key pin to click the "on/off" socket to unlock the battery

Please fasten the light to the pole by the bolt

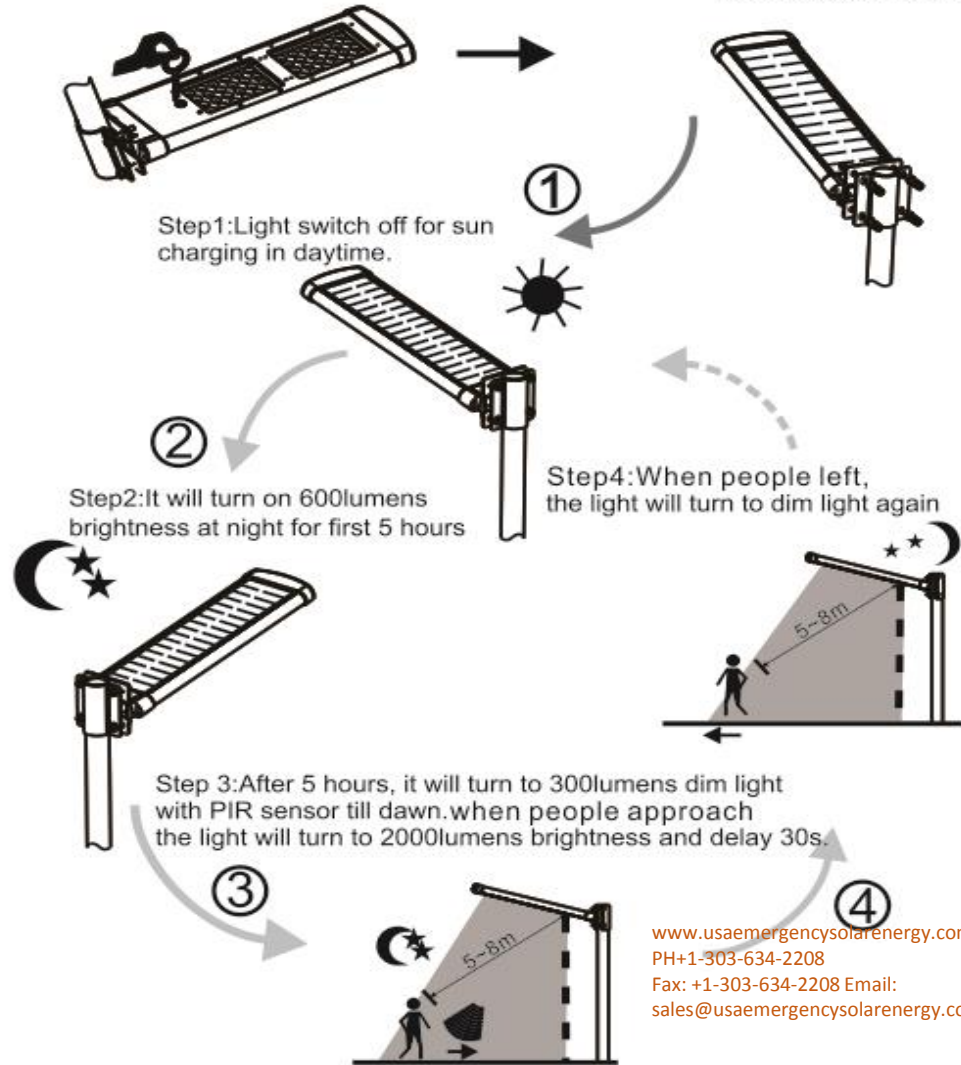

www.usaemergencysolarenergy.com
PH+1-303-634-2208
Fax: +1-303-634-2208 Email:
sales@usaemergencysolarenergy.com